

ALYSEA

THE SPECIALIZED INVERTER MONOSPLIT FOR INTERIOR COMFORT



 **OLIMPIA
SPLENDID**
HOME OF COMFORT

POSSIBLE INSTALLATION METHODS

ALYSEA E INVERTER | INSTALLATION |

STANDARD INSTALLATION CASES

- A** Rear pipe outlet
Perimeter wall
2 holes in the wall
- B** Side tube outlet
Interior or perimeter wall
1 hole in the wall

— Watch the installation video tutorial—



— Look at the installation manual—

<https://www.olimpiasplesdid.it/Downloadfile/OS266051>

INSTALLATION INTEGRATION OPTIONS FOR SPECIFIC CASES AND WITH COVER DUCT

- C** Rear pipe outlet
Perimeter wall
1 hole in the wall
Wall thickness < 25 cm
- D** Rear pipe outlet
Perimeter wall
2 unintersected holes in the wall
Wall thickness < 25 cm
- E** Rear and side tube outlet
Interior or perimeter wall
2 holes in the wall
Wall thickness > 25 cm
- F** Right-hand side pipe outlet
Interior or perimeter wall
1 hole in the wall
- G** Left-hand side pipe outlet
Interior or perimeter wall
1 hole in the wall

— View the document on the following pages—

ALYSEA E INVERTER | INSTALLATION |



The power cable with plug and the signal cable already wired, are due to the impossibility of accessing the internal terminal block, given the presence of the fan of the Fresh Air system (air intake from the outside).
If necessary, cut the two cables, extending them through a terminal block.

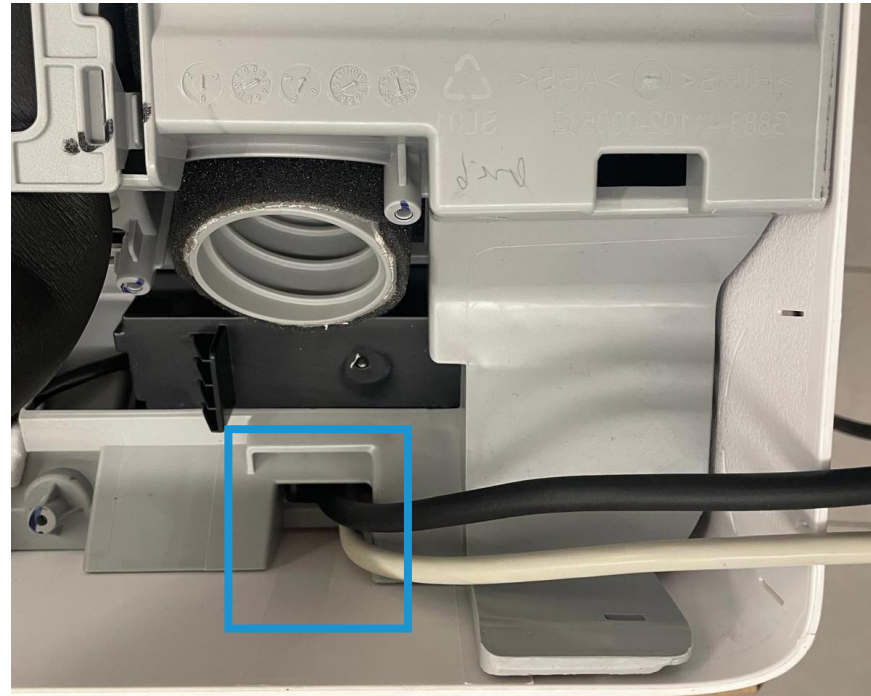

ALYSEA E INVERTER | INSTALLATION |



The document refers to installation integrations.
Always refer to the installation manual for clearances, drill holes,
and prepare indoor and outdoor unit connections.

INSTALLATION INTEGRATION OPTIONS FOR SPECIFIC CASES AND WITH COVER DUCT

- C** Rear pipe outlet
Perimeter wall
1 hole in the wall
Wall thickness < 25 cm
- D** Rear pipe outlet
Perimeter wall
2 unintersected holes in the wall
Wall thickness < 25 cm
- E** Rear and side tube outlet
Interior or perimeter wall
2 holes in the wall
Wall thickness > 25 cm
- F** Right-hand side pipe outlet
Interior or perimeter wall
1 hole in the wall
- G** Left-hand side pipe outlet
Interior or perimeter wall
1 hole in the wall

— View the document on the following pages—

ALYSEA E INVERTER | INSTALLATION |

To complete the various types of installation, one of the following accessories may be required (not supplied with the machine), as depending on the installation method adopted, they can be purchased in specialized stores (such as DIY).

(x)



80 mm 90° hole cover
(Curved wall passage
fitting for channel)

(y)



50 mm ventilation grille
for corrugated pipe air
intake

(z)

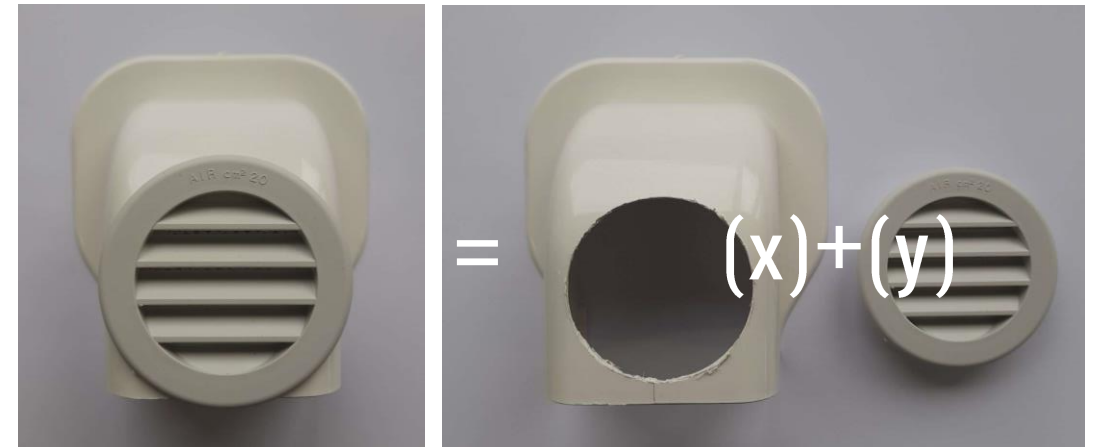

80 mm 90° hole cover bracket with
50 mm suction grille (for 1-hole
installation)

ALYSEA E INVERTER | INSTALLATION | CASE (C)

The hole (diameter 80 mm), located behind the indoor unit, houses the fresh air extension, the refrigerant pipes, the connection cable and the condensate drain.

In this installation, exiting with the fresh air extension and not with the rigid fresh air hose, the hole is covered by the 50 mm grille and the connection pipes by the hole cover (accessories not supplied (z)).

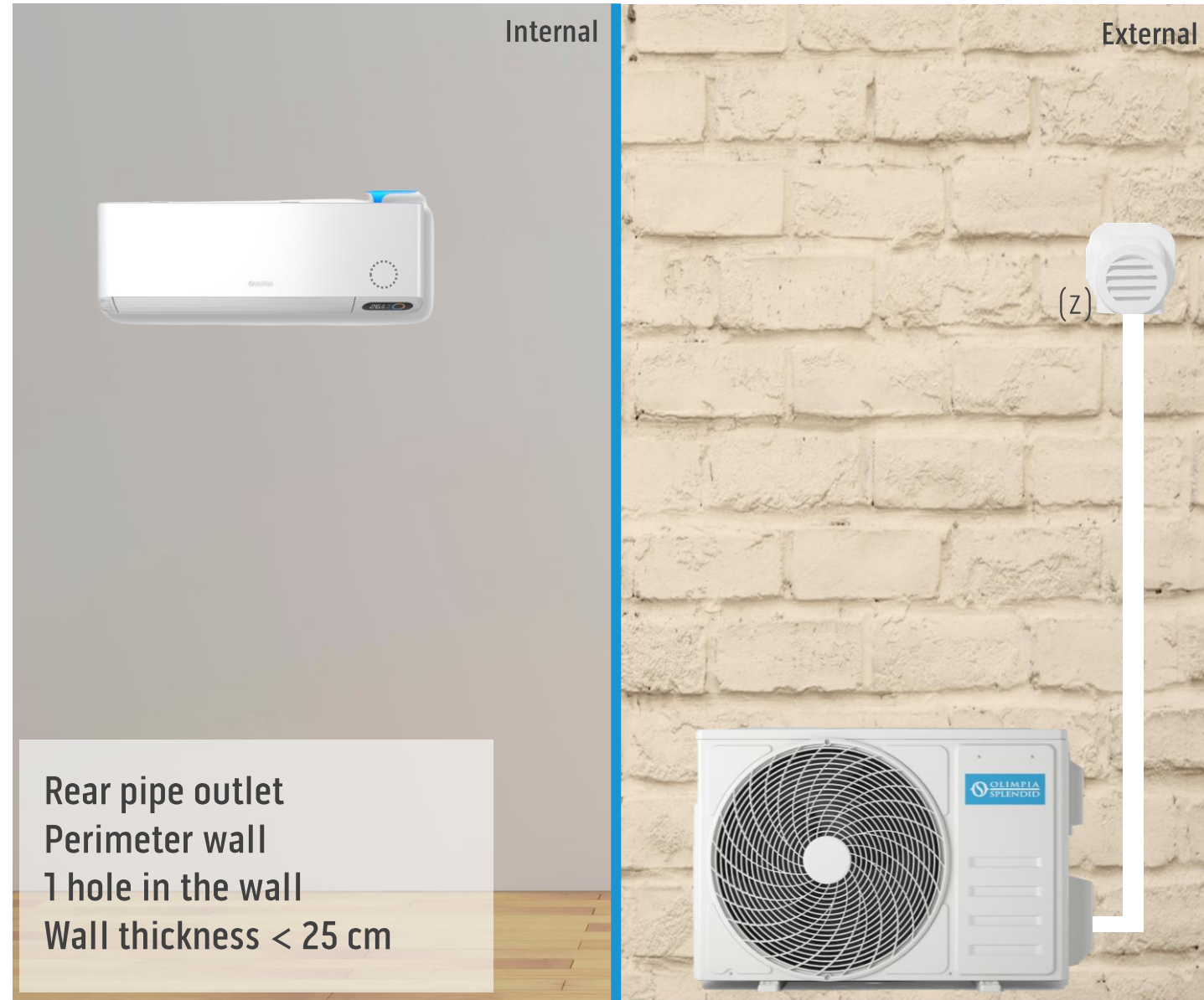

Internal

External

Rear pipe outlet
Perimeter wall
1 hole in the wall
Wall thickness < 25 cm

ALYSEA E INVERTER

INSTALLATION

CASE (D)

Two 50 mm diameter holes behind the indoor unit with 70 mm center distance.

Il primo foro (1), serve per il passaggio nel muro della Fresh air extension. The second hole (2) houses the refrigerant pipes, the connection cable and the condensate drain.

In this installation, exiting with the fresh air extension and not with the rigid fresh air hose, the hole is covered by the 50 mm grille and the connection pipes by the hole cover (accessories not supplied (x),(y)).

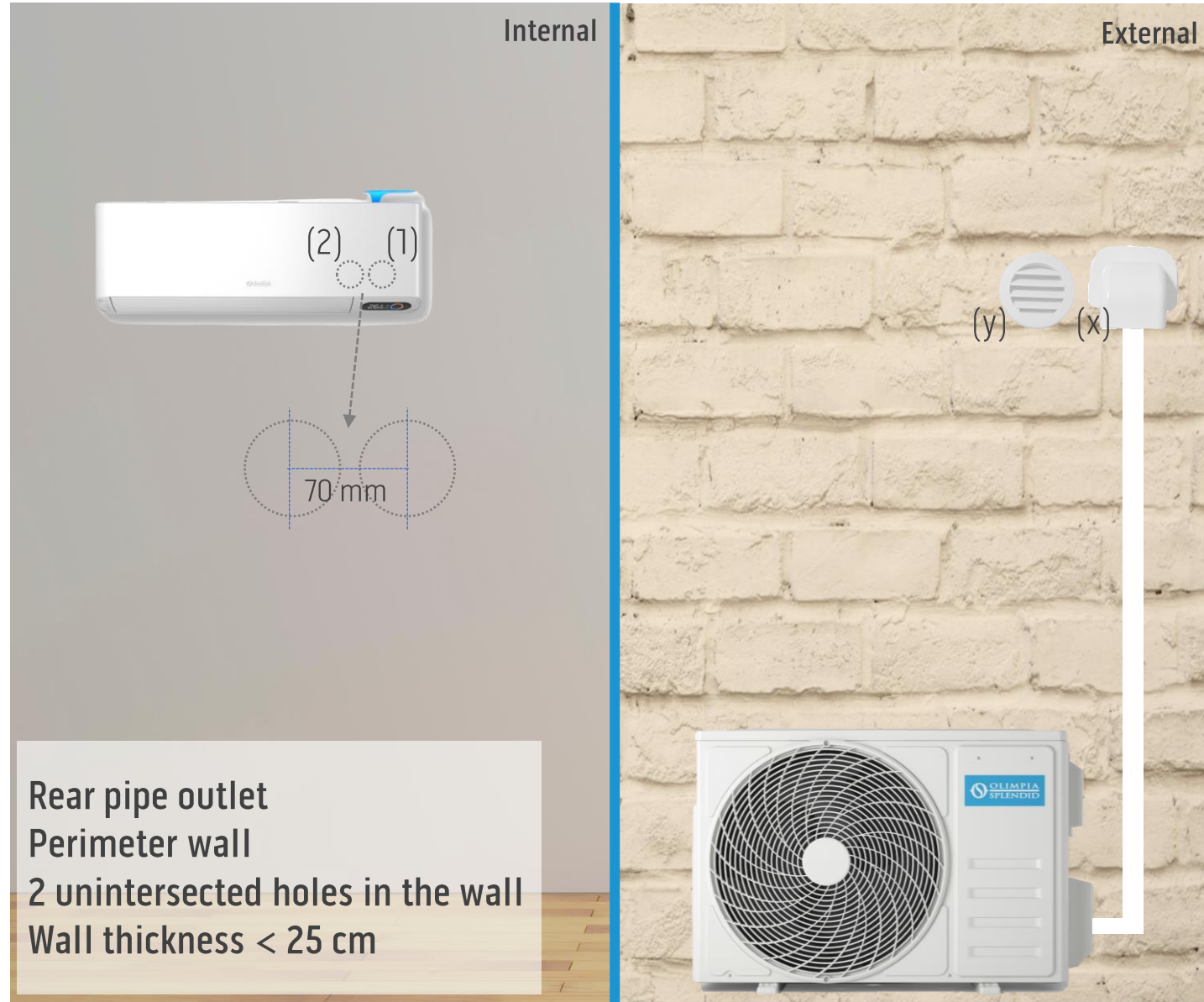

ALYSEA E INVERTER

INSTALLATION

CASE (E)

The first hole (1), with a diameter of 70 mm, is used to pass the rigid fresh air pipe (located behind the indoor unit) into the wall.

The second hole (2), with a diameter of 70 mm, houses the refrigerant pipes, the connection cable and the condensate drain (which must be blocked with the appropriate brackets) and is located to the left of the indoor unit (looking at it from the front) on the internal or perimeter wall. 90° bends are never possible on the perimeter wall.

The distance between the second hole and the indoor unit is at the discretion of the installer.

In this installation, the supplied protective net is replaced by the 50 mm grille (accessories not included (x),(y)).



ALYSEA E INVERTER | INSTALLATION | CASE (F)

Only 1 hole of 70 mm that houses the fresh air hose which then in turn contains the refrigerant pipes, the connection cable and the condensate drain.

The hole is located to the right of the indoor unit (looking at it from the front) on the internal or perimeter wall. 90° bends are never possible on the perimeter wall.

Maximum distance from the body of the indoor unit (right side) to the outside of the wall is 177 cm.

In this installation, the supplied protective net is replaced by the 50 mm grille (accessories not supplied (z)).

This is the case (B) shown in the "video tutorial" but with the addition of the accessories not supplied.

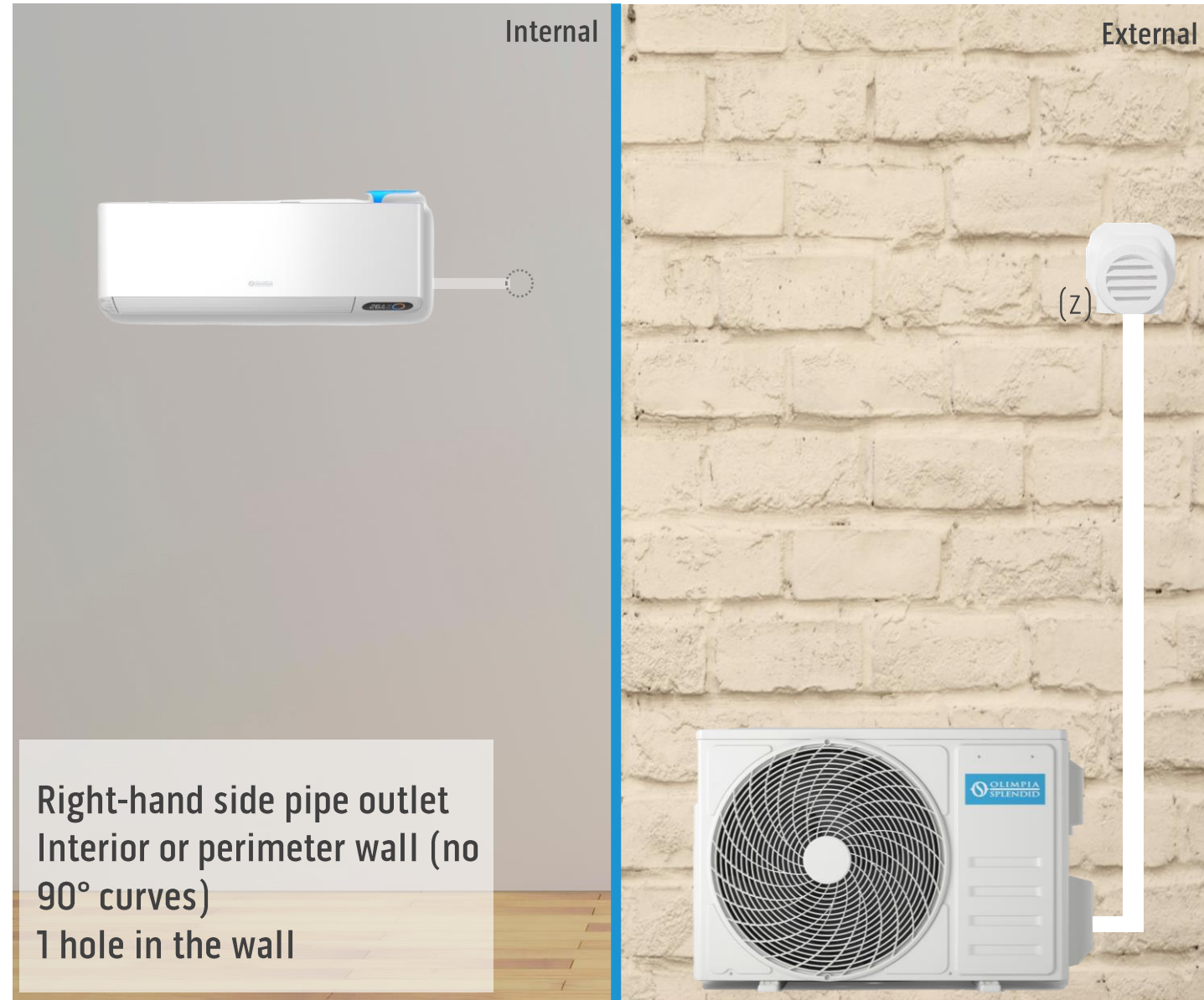

Right-hand side pipe outlet
Interior or perimeter wall (no
90° curves)
1 hole in the wall

ALYSEA E INVERTER

INSTALLATION

CASE (G)

If the previous installations are not possible, it is possible to exit on the left, taking care to ensure that the fresh air hose, the refrigerant pipes, the connection cable and the condensate drain behind the machine are correctly housed, blocking them with the appropriate brackets.

A 70 mm hole that houses the fresh air pipe which then in turn contains the refrigerant pipes, the connection cable and the condensate drain.

The hole is located to the left of the indoor unit (looking at it from the front) on the internal or perimeter wall. 90° bends are never possible on the perimeter wall.

Maximum distance from the body of the indoor unit (left side) to the outside of the wall is 114 cm

In this installation, the supplied protective net is replaced by the 50 mm grille (accessories not supplied (z)).

This is the case (B) shown in the "video tutorial" but with the addition of the accessories not supplied.

